

MAIN CAMPUS

CALIFORNIA POLYTECHNIC STATE UNIVERSITY

1991

1" inch = 400' feet 1 square inch = 3.67 acres

Cartography based on scaled meters from W.A.C. Corp. aerial photography, 1985; U.S.G.S. Morro Bay and San Luis Obispo 7.5 minute quadrangles, 1976 and field surveys by J. V. Stechman. Additional detailed maps of soils and cropland available from pertinent departments, and of contours and utilities, from Plant Operations Plan Room, Cal Poly (nd) (follow cartographic accuracy ±4%).

T, 30 S, R, 12 E₄

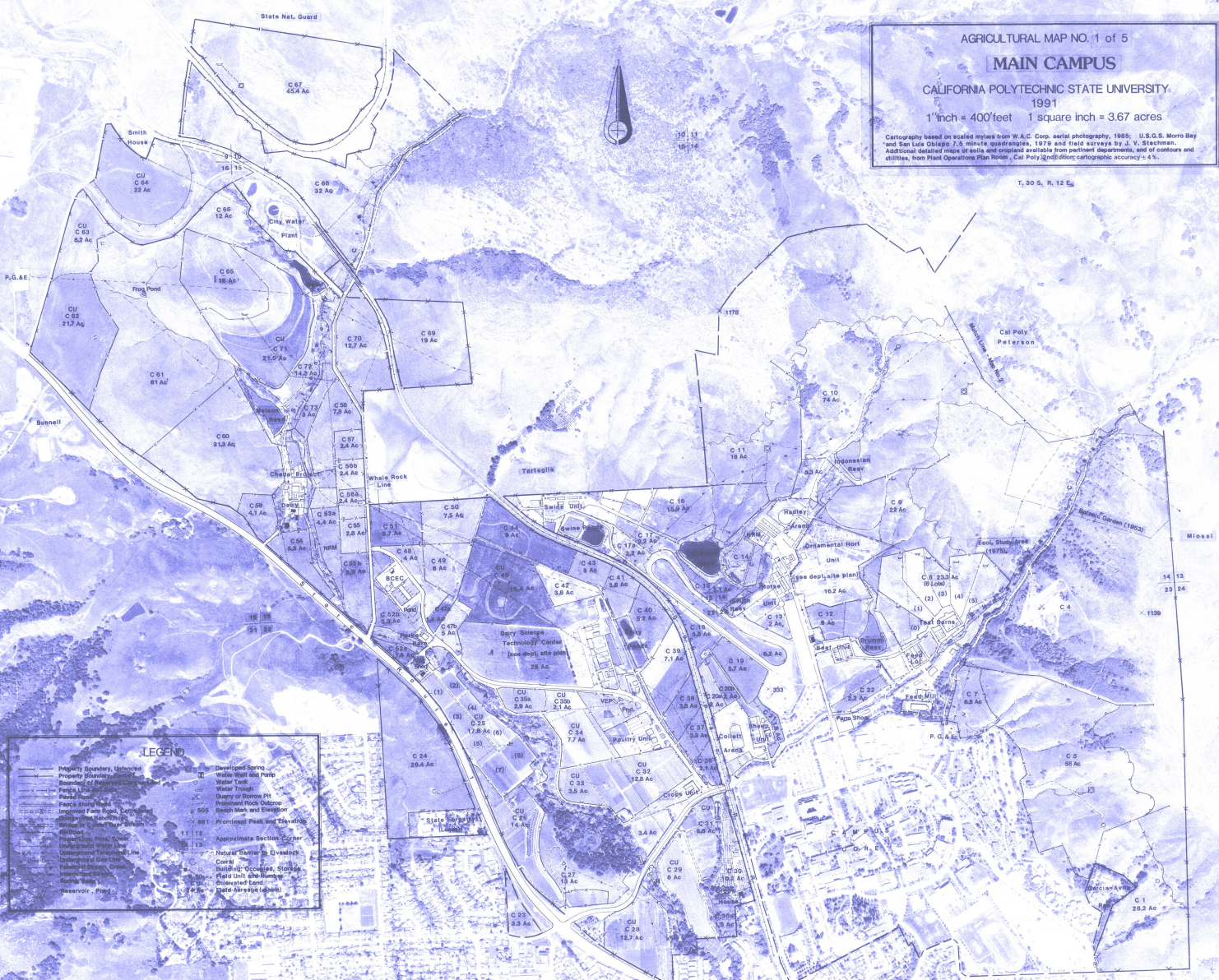

LEGEND

	Property Boundary, Unbordered		Developed Sprinkler
	Property Boundary, Bordered		Water Wall and Pond
	Boundary of Building		Water Trough
	Fence Line, Bordered		Quarry or Storage Pit
	Fence Line, Unbordered		Promotional Rock Outcrop
	Improved Farm Road, Unbordered		South Mark and Blotter
	Improved Farm Road, Bordered		Frontyard Paved Area
	Utility Line, Power		Approximate Section Corner
	Utility Line, Water		Natural Barrier or Obstacle
	Utility Line, Sewer		Contour
	Utility Line, Gas		Building - Occupied, Storage
	Utility Line, Other		Field Unit - Occupied, Storage
	State Acreage Label		Cultivated Land
	Reservoir, Pond		State Acreage Label

AGRICULTURAL MAP NO. 12 of 16

SERRANO AND PETERSON RANCHES

CALIFORNIA POLYTECHNIC STATE UNIVERSITY
1991

1" inch = 400 feet 1 square inch = 3.67 acres

Cartography based on aerial photos from W.A.C. Deane's Aerial Photography 1988, U.S.G.S. Micro Bay and San Luis Obispo 7.5 minute quadrangle, 1978 and 1984, and University of C.A. Stetson. Additional details from aerial photo and ground inspections. Approximate location, road, contours and utilities, from Plant Operations Plan Room, Cal Poly, San Luis Obispo, California, 1977, 78.

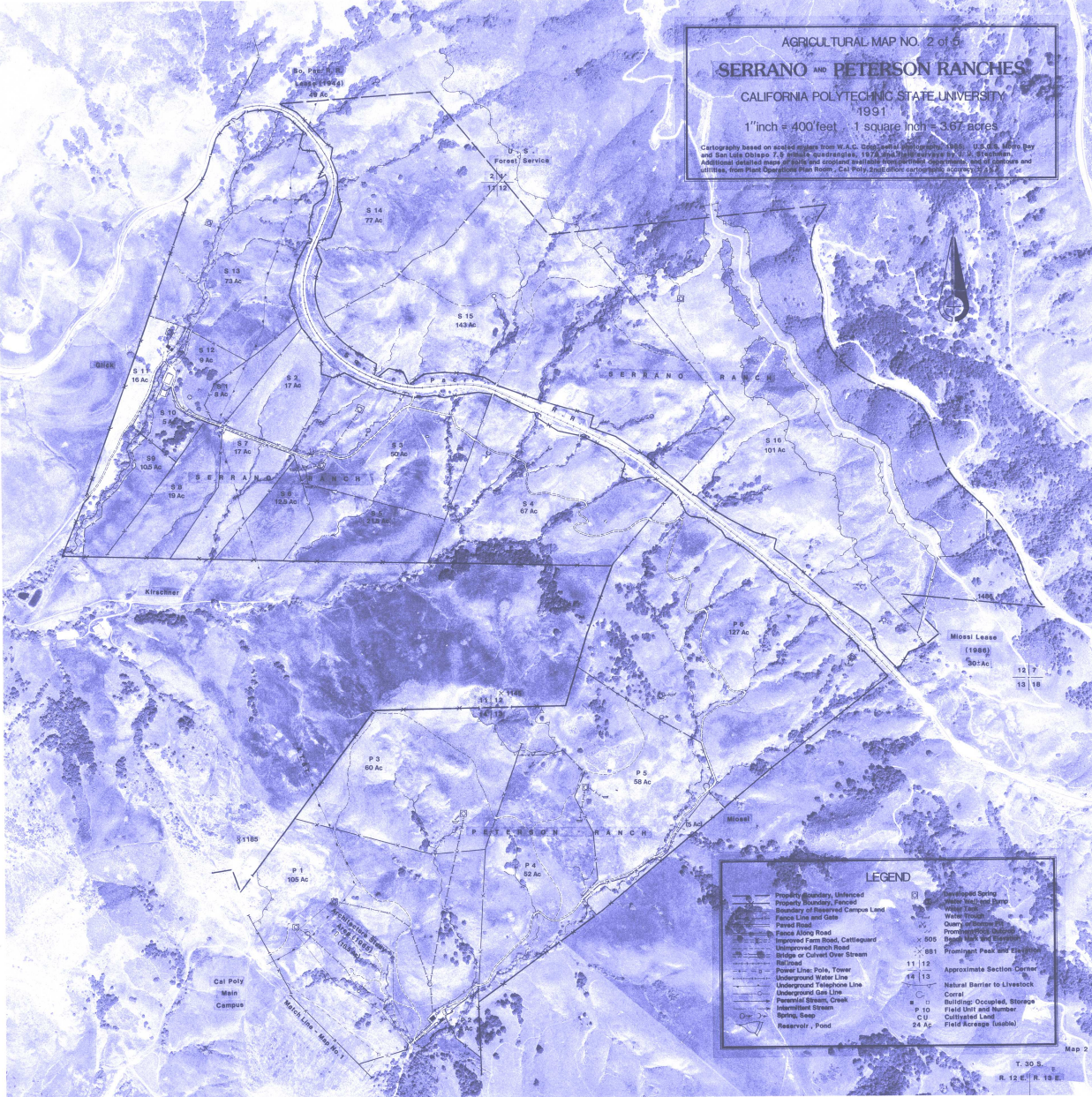

LEGEND

- Property Boundary, Unfenced
- Property Boundary, Fenced
- Boundary of Reserved Campus Land
- Fence Line and Gate
- Fenced Road
- Fence Along Road
- Improved Farm Road, Cattleguard
- Unimproved Ranch Road
- Bridge or Culvert Over Stream
- Railroad
- Power Line, Pole, Tower
- Underground Water Line
- Underground Telephone Line
- Underground Gas Line
- Pressurized Steam, Creek
- Intermittent Steam
- Water Pipe
- Reservoir, Pond
- Unimproved Pasture
- Water Tank
- Quarry or Refill Site
- Power Transformer
- Hog Pen and Pig Barnyard
- Prominent Peak and Elevation
- 11 12
- 14 13
- 12 7
- 13 18
- Natural Barrier to Livestock
- Corral
- Building, Occupied, Storage
- Field Unit and Number
- Cultivated Land
- Field Access (Sublot)

Map 2

T. 30 S.
R. 12 E. R. 10 E.

AGRICULTURAL MAP NO. 3 of 5
CHORRO CREEK AND SOUTH WALTERS RANCHES

CALIFORNIA POLYTECHNIC STATE UNIVERSITY
 1988

1" inch = 400' feet 1 square inch = 3.67 acres

Cartography based on scaled meters from W.A.C. Corp. aerial photography, 1985; U.S.G.S. Morro Bay and San Luis Obispo 7.5 minute quadrangles; 1979 and field surveys by J. V. Stechman. Additional detailed maps of wells and cropped available from pertinent departments, and of contours and utilities, from Plant Operations Plant Room, Cal Poly. 1st Edition cartographic accuracy 5:4.

T. 30 S. R. 11 E.



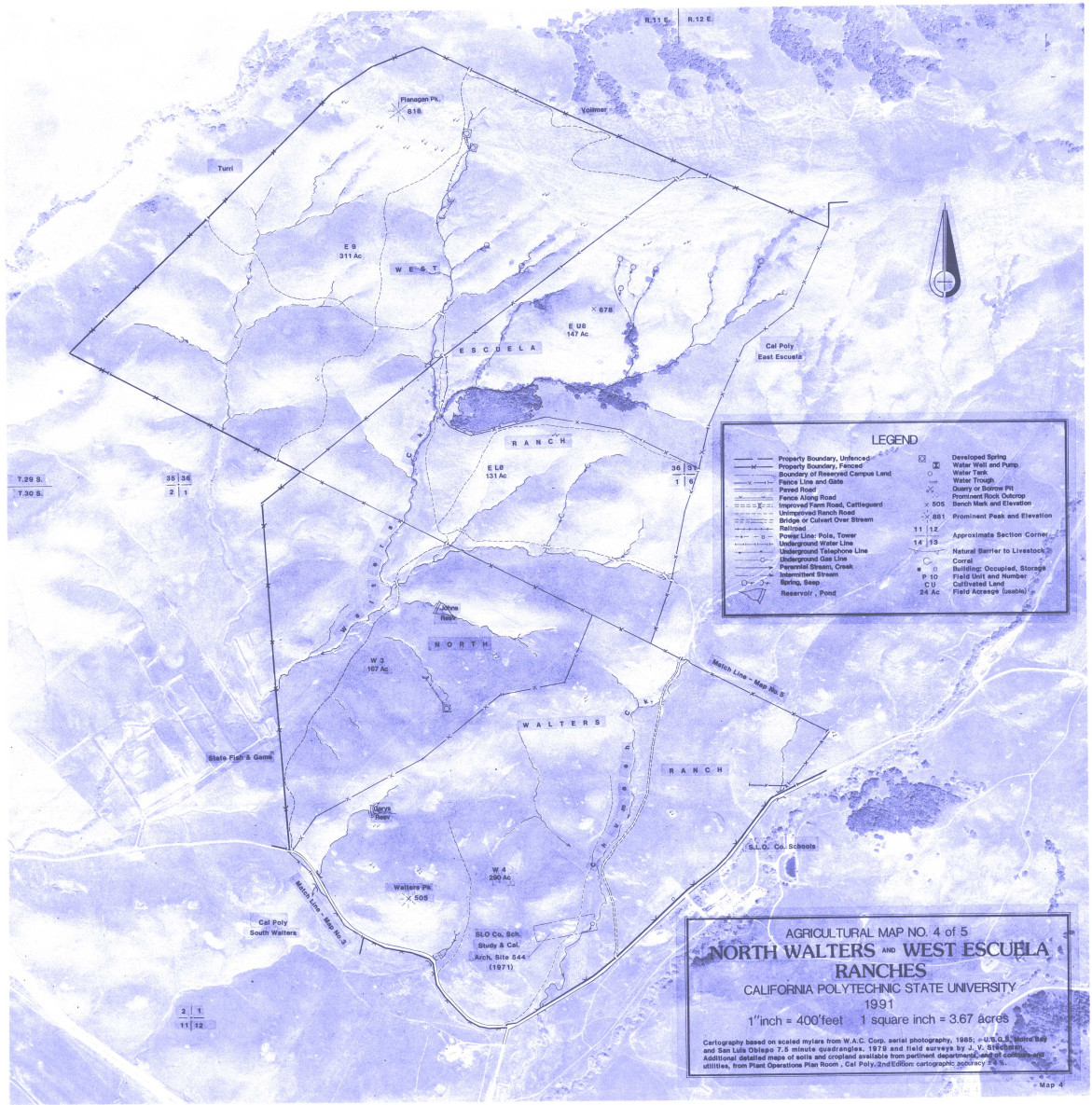

LEGEND

	Property Boundary, Unfenced		Developed Siting
	Property Boundary, Fenced		Water Well and Pump
	Boundary of Reserved Campus Land		Water Tank
	Fence Line and Gate		Water Trough
	Paved Road		Quarry or Barrow Pit
	Fence Along Road		Prominent Bench Outcrop
	Improved Farm Road, Cattlepaved		505 Bench Mark and Elevation
	Unimproved Farm Road		881 Prominent Peak and Elevation
	Bridge or Culvert Over Stream		11 12 Approximate Section Corner
	Railroad		14 18 Approximate Section Corner
	Power Line: Pole Tower		14 18 Natural Barrier to Livestock
	Underground Water Line		Corral
	Underground Telephone Line		Building, Occupied, Storage
	Underground Gas Line		P 10 Field Unit and Number
	Paved Stream, Creek		C 11 Cultivated Land
	Intermittent Stream		24 Ac Field Acreage (usable)
	Barrow, Deep		
	Reservoir, Pond		

AGRICULTURAL MAP NO. 4 of 5
NORTH WALTERS and WEST ESCUELA
RANCHES
 CALIFORNIA POLYTECHNIC STATE UNIVERSITY
 1991
 1" inch = 400' feet 1 square inch = 3.67 acres

Cartography based on scaled mylars from W.A.C. Corp. aerial photography, 1985; U.S.G.S. (Home-Bed) and San Luis Obispo 7.5 minute quadrangles, 1970 and field surveys by V. V. Vukobratovic. Additional detailed maps of acre and cropland available from pertinent departments, and of contours and utilities, from Plant Operations Plan Room, Cal Poly, 2nd Edition cartographic copywork 1988.

AGRICULTURAL MAP NO. 5 of 5.

EAST ESCUELA RANCH

CALIFORNIA POLYTECHNIC STATE UNIVERSITY
1991

1" inch = 400 feet 1 square inch = 3.67 acres

Cartography based on scaled meters from W.A.C. Corp. aerial photography, 1985; U.S.G.S. Monrovia and San Luis Obispo 7.5 minute quadrangles; 1979 and field surveys by J. V. Stockman. Additional detailed maps of wells and cropped available from pertinent departments, and of contours and utilities, from Plant Operations Plan Room, Cal Poly, 2nd Edition; cartographic accuracy: 4%.



Cal Poly West Escuelo

36 | 51

1 | 6

Cal Poly North Walters

Vollmer Pk.

1:1000

EAST ESCUELA RANCH

Upper Resv.

Lower Resv.

Vollmer Resv.

County Schools

C.P. - CUPHY NMA (1970)
17 Ac

Vollmer Resv.

5 Ac

County Schools

Lim

Lim

Lim

Lim

Lim

Lim

Lim

Lim

Lim

Lim

Lim

Lim

Lim

Lim

Lim

Lim

Lim

Lim

Lim

Lim

Lim

LEGEND			
	Property Boundary, Unfenced		Developed Spring
	Property Boundary, Fenced		Water Well and Pump
	Boundary of Reserved Campus Land		Water Tank
	Fence Line and Gate		Water Trough
	Fenced Road		Quarry or Borrow Pit
	Fence Along Road		Prominent Rock Outcrop
	Improved Farm Road, Cattleguard		S bench Mark and Elevation
	Unimproved Ranch Road		505
	Balance or Culvert Over Stream		881
	Railroad		11 12
	Power Line, Pole, Tower		14 13
	Underground Water Line		Natural Barrier to Livestock
	Underground Telephone Line		Corral
	Underground Gas Line		Barren, Occupied, Storage
	Powerline Stream, Creek		Field Unit and Number
	Intermittent Stream		P 10
	Spring, Seep		CU
	Reservoir, Pond		24 Ac.
			Field Acreage (usable)